

Magnetic Sensor Latch Output Type

HGP□P Series



Best suited for rotation mechanism using the small size and high precision latch output type.

Magnetic Sensors

Piezo Sensors

Capacitive Sensor

Resistive Sensors



HGPJPM001A

HGPFPPT001A

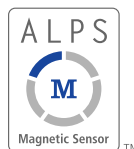

Minimum order unit (pcs.): 3,000 pcs.

Typical Specifications / Product list

Items	Specifications	
	HGPJPM001A	HGPFPPT001A
Function	1-phase alternating output	
Drive voltage	Typ. 1.8V (1.6V min. to 3.6V max.)	Typ. 5V (4.5V min. to 5.5V max.)
Sampling period	1.3m sec	35Bsec
Current consumption	10 μ A Ave. (at VDD= 1.8V)	2mA Ave. (at VDD= 5V)
Operating magnetic field	Hon	+1mT
	Hoff	-1mT
Operating temperature range	-40°C to +115°C	

Packing Specifications

Taping

Unit:mm

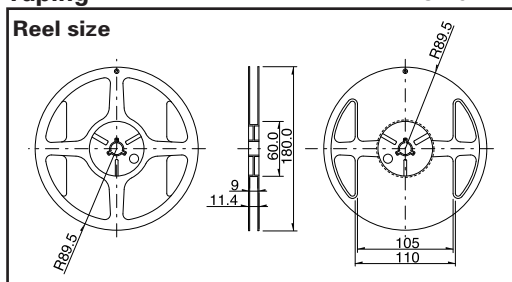

Number of packages (pcs.)			Tape width (mm)	Export package measurements (mm)
1 reel	1 case /Japan	1 case /export packing		
3,000	3,000	45,000	8	210 × 210 × 230

Dimensions

Unit:mm

Style	
<p>HGPJPM001A</p>	<p>HGPFPPT001A</p>

Note

Please place purchase orders per minimum order unit N (integer).



Automotive Use

Index for Functions

Style	Series	Photo	Type	Package / Size		Function	Drive voltage	Operating magnetic field	Automotive use	Page			
Magnetic	HGDE□		Switching output (Detection switch)	MAP	1.3×0.9×0.55mm	Single polarity / Single output	Typ.1.8V	Hon 2.0mT		499			
						Dual polarity / Single output							
				SON	2.1×2.1×0.75mm	Single polarity / Single output							
						Dual polarity / Single output							
				SOT23	2.9×2.8×1.1mm	Single polarity / Single output							
						Dual polarity / Single output							
	SON	2.1×2.1×0.75mm	Single polarity / Single output	Typ.5V									
			Dual polarity / Single output										
	SOT23	2.9×2.8×1.1mm	Single polarity / Single output										
			Dual polarity / Single output										
	HGDFPA□		Switching output (Connector Connection Model)	14×9×5mm	Dual polarity / Single Output (open collector output)	Typ.5V	—	501					
						Typ.12V							
HGDF□		Snap-in type	14.15×13.2×5mm	Dual polarity / Single output	Typ.5V	Hon 0.6mT	502						
HGP□P		Latch output type (direction of rotation)	MAP	1.3×0.9×0.55mm	1-phase alternating output Sampling period 1.3msec	Typ.1.8V	Hon 1mT/ Hoff -1mT	●	503				
					SOT23					2.9×2.8×1.1mm	1-phase alternating output Sampling period 35μ sec	Typ.5V	
			HGP□D		Incremental encoding output (direction of rotation/rotation direction)	MAP				2×1×0.55mm	2-phase alternating output Sampling period 1.3msec	Typ.1.8V	
											SOT23		2.9×2.8×1.1mm
			HGAR□		Linear analog output (Rotation detection)	2×1.5×0.65mm				Output:Typ.±75mV (rotation angle±30°)	1.5 to 5.5V	—	505
Geomagnetic	HSCD□		Geomagnetic detection	2.5×2.5×0.7mm		Output resolution 0.3 μT / LSB	Ana:2.4 to 3.6V Digi:1.7 to 2.3V	±0.6mT	—	506			

Magnetic Sensors
Piezo Sensors
Resistive Sensors
Resistive Sensors

Note

●marks in "Available for automotive use" indicate that all of the series products can work at the operating temperature range from -40°C to +85°C.