

Magnetic Sensor Geomagnetic Sensor

HSCD Series

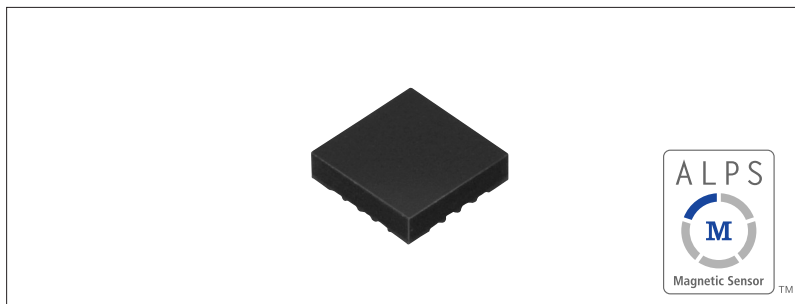

This electric Compass device is most suitable for being embedded in small devices and mobile devices.



Minimum order unit (pcs.) : 3,000 pcs.

Magnetic Sensors

Piezo Sensors

Capacitive Sensor

Resistive Sensors

Typical Specifications

Items	Specifications
Size	2.5 × 2.5 × 0.7mm
Output resolution	0.3μT/LSB
Measurement range	±0.6mT
Current consumption	200μA max.
AV _{DD} : Drive voltage (Operating voltage)	+2.4 to +3.6V
DV _{DD_io} : Drive voltage (Operating voltage)	+1.7 to +2.3V
Interface	I ² C
Operating temperature range	-20°C to +85°C

Packing Specifications

Taping

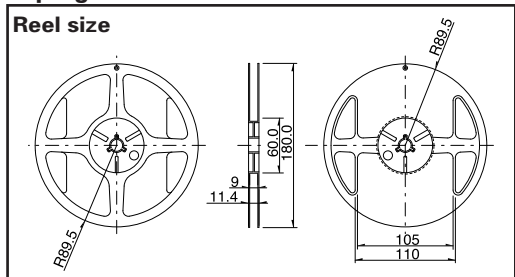

Number of packages (pcs.)			Tape width (mm)	Export package measurements (mm)
1 reel	1 case /Japan	1 case /export packing		
3,000	3,000	45,000	8	210 × 210 × 230

Dimensions

Unit:mm

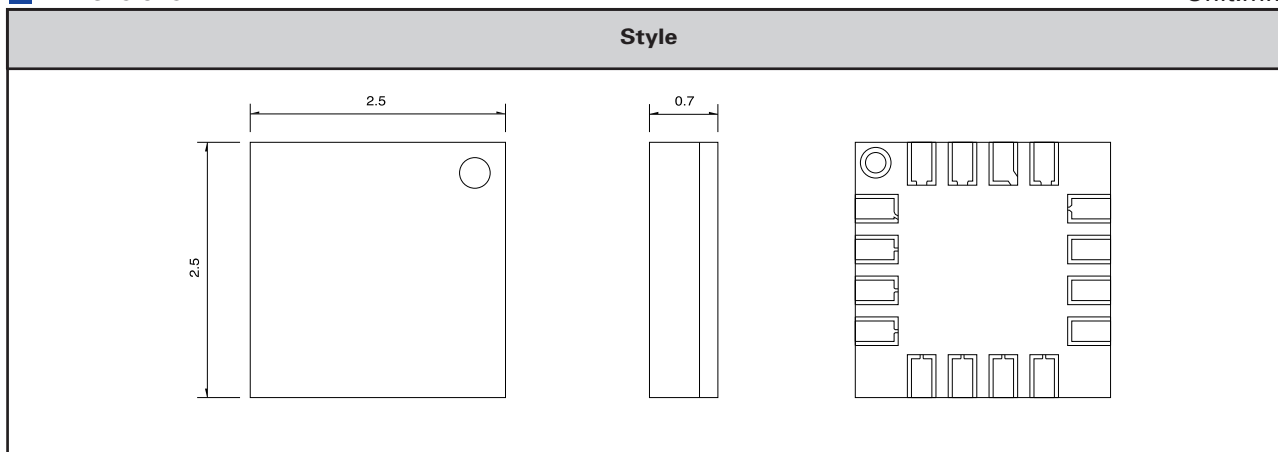

Note

Please place purchase orders per minimum order unit N (integer).

Index for Functions

Style	Series	Photo	Type	Package / Size	Function	Drive voltage	Operating magnetic field	Automotive use	Page	
Magnetic	HGDE□		Switching output (Detection switch)	MAP	1.3×0.9×0.55mm	Single polarity / Single output Dual polarity / Single output Dual polarity / Dual output	Typ.1.8V	Hon 2.0mT	499	
				SON	2.1×2.1×0.75mm	Single polarity / Single output Dual polarity / Single output Dual polarity / Dual output				
				SOT23	2.9×2.8×1.1mm	Single polarity / Single output Dual polarity / Single output				
				SON	2.1×2.1×0.75mm	Single polarity / Single output Dual polarity / Single output Dual polarity / Dual output				
				SOT23	2.9×2.8×1.1mm	Single polarity / Single output Dual polarity / Single output				
				HGDF□	SON	2.1×2.1×0.75mm				Single polarity / Single output Dual polarity / Single output Dual polarity / Dual output
	HGDFPA□		Switching output (Connector Connection Model)	14×9×5mm	Dual polarity / Single Output (open collector output)	Typ.5V Typ.12V	—	—	501	
			Snap-in type	14.15×13.2×5mm	Dual polarity / Single output	Typ.5V	Hon 0.6mT	—	502	
	HGP□P		Latch output type (direction of rotation)	MAP	1.3×0.9×0.55mm	1-phase alternating output Sampling period 1.3msec	Typ.1.8V	Hon 1mT/ Hoff -1mT	●	503
				SOT23	2.9×2.8×1.1mm	1-phase alternating output Sampling period 35μ sec	Typ.5V			
HGP□D		Incremental encoding output (direction of rotation/rotation direction)	MAP	2×1×0.55mm	2-phase alternating output Sampling period 1.3msec	Typ.1.8V	Hon 1mT/ Hoff -1mT	●	504	
			SOT23	2.9×2.8×1.1mm	2-phase alternating output Sampling period 35μ sec	Typ.5V				
HGAR□		Linear analog output (Rotation detection)	2×1.5×0.65mm	Output:Typ.±75mV (rotation angle±30°)	1.5 to 5.5V	—	—	505		
Geomagnetic	HSCD□		Geomagnetic detection	2.5×2.5×0.7mm	Output resolution 0.3 μT / LSB	Ana:2.4 to 3.6V Digi:1.7 to 2.3V	±0.6mT	—	506	

Magnetic Sensors
Piezo Sensors
Resistive Sensors
Resistive Sensors

Note

●marks in "Available for automotive use" indicate that all of the series products can work at the operating temperature range from -40°C to +85°C.